

Swivel Spout Stainless Steel | 115.0638.826

FAMILY : Taps | SERIE : Atlas Neo Sensor | MODEL : Swivel Spout | FINISH : Stainless Steel | FEATURES : Sensor Tap

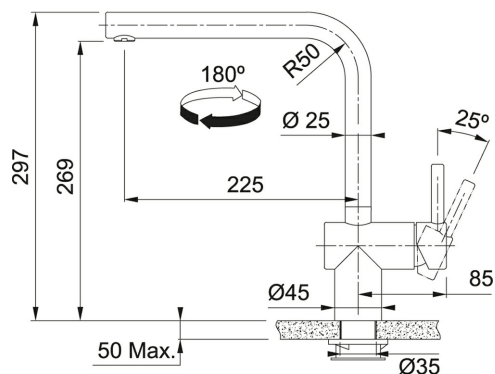

The Atlas Sensor tap is made of Solid Stainless Steel which has a hygienic, non-porous surface that is resistant to bacteria and germs. Once in use, the water will flow continuously for 30 seconds. The tap can be stopped with a wave, as well as started so, you don't have to wait 30 seconds.

- Hybrid function enabling manual lever for everyday use and sensor activity for hand washing.
- The touchless and manual controls operate independently from each other.
- The sensor screen is easy to keep clean and easy to use.
- The sensor controls the touch free water temperature.
- If unintentionally started and once activated, the water flow stops in less than a second!
- The temperature on the sensor is set upon installation in the control box under the sink.
- Quick and easy plug-in installation: the tap, the control box, and the battery.

TECHNICAL DATA

Tap Pressure	High Pressure
Tap Operation	Side Lever
Water Mixing Cartridge	Ø 35
Tap rotation	180 °
Type of aerator	laminar
Height Overall	297.00 mm
Height to End of Spout	269.00 mm
Spout reach	225.00 mm
Base	Ø-45
Cabinet Size	45
Type of Material	stainless steel
Type	MIXER-TAP
Hot Flow Rate at 0.3 bar	1.91 litres/min
Suitable for low pressure system	No
Price	£573.00

FEATURES

-  Soft (85÷130°C)
- Defrost (25°C)
- Rising (30°C)
- Quick Defrost (35÷55°C)
- Keep Warm (60÷85°C)